

NCTK Series

AC CURRENT SENSORS



■特点

- 开合式(分割)式安装方便
- 方便安装
- 结构紧凑且宽量程
- 高线性度
- 直接接口
- 阻燃性UL94V-0

■用途

- 电能计量/能效管理用
- HEMS (家庭能源管理系统)
- BEMS (建筑能源管理系统)
- 其它在线电能监控系统

■型号表示 PART NUMBER DESIGNATION

系列 Series Name	SCT
----------------	-----

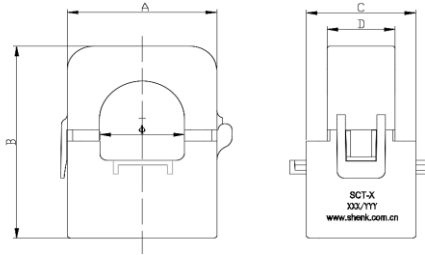

■FEATURES

- Clamp-on type (split core design)
- Easy installation to distribution panels
- Compact size and wide measuring range
- Outstanding output linearity at all current ranges
- Direct interface
- Overvoltage protection (zener diode)
- UL94V-0 flame rating

■APPLICATIONS

- To measure or monitor current or power consumption in smart energy systems such
- HEMS (Home Energy Management System)
- BEMS (Building Energy Management System)
- Various power monitoring systems

- 16

内径Hole Diameter
16: φ 16mm

■型号一览表 LIST OF MODEL NUMBER

型号 Part Number	内径φ Hole Diameter	A	B	C	D
SCT-10	10	23	41	26	14
SCT-16	16	30	47	32	19
SCT-24	24	46	64	34	22
SCT-36	36	56	82	43	26
SCT-50	47	80	110	47	32

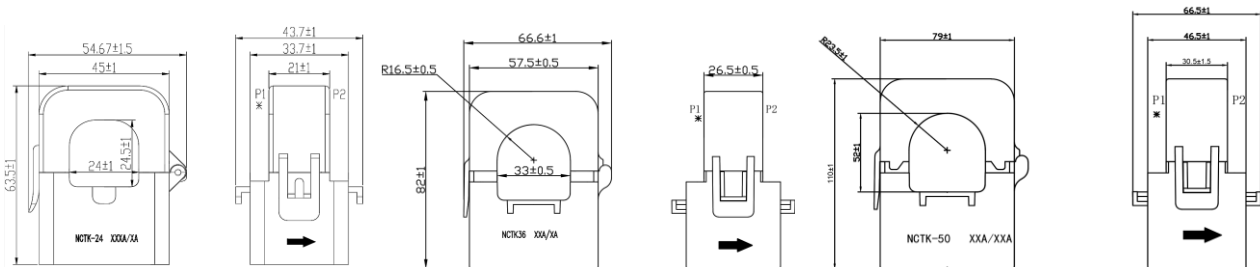

■规格 SPECIFICATIONS

型号 Part Number	GCT-10	GCT-16	GCT-24	GCT-36	GCT-50
适用电流 Rated Primary Current	1~60A	5~100A	5~300A	5~600A	5~1000A
可选规格 (A) Optional specification	5A、20A、30A 40A、50A、60A	50A、100A	100A、120A、200A、 250A	200A、400A、600A	400A、600A、800A、 1000A
毫安级输出常规变比 (T) Conventional Turns ratio	1000:1~3000:1	1000:1-5000:1	1000:1-8000:1	1000:1-12000:1	1000:1-12000:1
安培级输出规格 Ampere-level output specifications	/	100A/1A-5A 5.0 0VA	100A/1A-5A 1.0 1.5VA 150A/1A-5A 1.0 1.5VA 200A/1A-5A 1.0 1.5VA 250A/1A-5A 1.0 1.5VA 300A/1A-5A 1.0 1.5VA	200A/1A-5A 1.0 1.5VA 250A/1A-5A 1.0 1.5VA 300A/1A-5A 0.5 1.5VA 400A/1A-5A 0.5 1.5VA 500A/1A-5A 0.5 2.5VA 600A/1A-5A 0.5 2.5VA	400A/1A-5A 0.5 1.5VA 500A/1A-5A 0.5 2.5VA 600A/1A-5A 0.5 2.5VA 800A/1A-5A 0.5 2.5VA
精度 Tolerance	毫安级精度：0.5%，安培级精度见上表				
二次线 Output Cable lead	UL2468 24AWG、UL2468 16AWG、UL1015 22AWG 线长1米可定制				
适用频率 Applicable Frequency	50/60Hz				
最大电压 Max. Circuit Voltage	Less than AC300V~600V (绝缘电缆 for insulated cable)				
绝缘耐压 Withstanding Voltage	AC 4000V/1 minute (输出端与外部情况 between output terminal and outer case)				
绝缘电阻 Insulation Resistance	More than 100MΩ by 500V insulation tester (输出端与外部情况 between output terminal and outer case)				
使用温湿度 Operational Temperature	-25 ~ 60°C less than 80%RH				
保存温湿度 Storage Temperature	-30 ~ 90°C less than 80%RH				
阻燃等级 Flame Rating	Shell 外壳 UL 94V-0 Second line 二次线 UL VW-1				